

# FUSION

## EX-1

Design by  
Dustin Peckham

USA

CASTER  
RACING

CASTER  
RACING

- ▲ 100% Pre-built
- ▲ Pistol grip transmitter with servo reverse and EPA function
- ▲ High torque ball raced steering servo 9kg
- ▲ 24 Rubber sealed ball bearings
- ▲ Countersunk T6 CNC-machined aluminium chassis
- ▲ CNC-machined T6 aluminium radioplate
- ▲ CNC-machined T6 aluminium center diff. plate
- ▲ CNC-machined T6 aluminium servo saver plate
- ▲ CNC-machined T6 aluminium rear shock tower
- ▲ CNC-machined T6 aluminium front shock tower
- ▲ Glassfibre reinforced chassis stiffener FR&RE
- ▲ Rear anti-roll bar
- ▲ CVD universal joints front
- ▲ 3 differentials with 6 planetary gears
- ▲ Steel bevel gears
- ▲ Double disc brake
- ▲ 4 hydraulic hard coated aluminium constant volume shock absorbers
- ▲ Moulded side guards
- ▲ Dust proof receiver box
- ▲ Adjustable wing mount
- ▲ Pre-painted polycarbonate body





## Please read all instructions thoroughly before assembling the kit.

The contents are subject to change without prior notice due to product improvement and specification change.

# CASTER

### Performance Features of the Fusion EX-1 Kit

- Extreme Low Diff. CG.
- Pro Steering Geometry Angle
- Two piece Pro Center Diff. mount
- Anodized Aluminum Radio Plate
- CNC Spur, Crown and Pinion Gears
- 3 Shoe Clutch
- Shock Shaft 3.5mm
- Extreme Light Diff. system.
- Anodized F / R Aluminum Arm Holder
- 3.2mm Anodized Main Chassis
- Optional Shock Springs included.
- Low Profile Radio Box
- Front CVD
- Increased suspension travel to 7cm
- Lower CG Design through out the car
- Lay Down Steering Servo
- Full Ball Bearing through out the car
- Pro Turnbuckles
- Pro Brake Pad

Thank you and congratulations on your purchase of the Caster Racing Fusion EX-1R 1/8th radio controlled model. Please read through this instruction manual carefully before you attempt to assemble or operate your Fusion EX-1R buggy kit. This manual contains building steps and instructions you will use to set up your RTR, KIT and Pro Fusion EX-1R buggies. Follow the directions in this manual closely and take the time to study, reference and understand your Fusion EX-1R manual is the key to ensure the maximum performance and longevity from your new Fusion EX-1R. We hope that you will enjoy your new Caster Racing Buggy. If you ever have any questions or need help with your Fusion EX-1R please feel free to contact our official Caster Racing dealers and distributors, as they will always be happy to help you. Good Luck and Enjoy the Racing Fun.

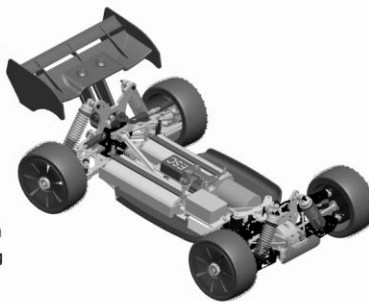

#### TECHNICAL INFORMATION (RTR)

- 3 Diff. Shaft Drive 4WD
- CVD (Front)
- Anodized Shock Body w/ 3.5mm shaft
- A7075 (T6) 3.2mm Main Chassis
- A7075 (T6) 3.2mm F/R Shock Tower
- Receiver & Battery Box
- 3pcs. Racing Clutch Shoe
- Anodized (T6) Radio Plate
- Anodized (T6) Center Diff. Mount Plate
- Anodized (T6) Steering Plate
- 2pcs. Center Diff. Mount
- CNC Diff. Gears
- Clear Body
- Length :478-485mm
- Width :308
- Height :181mm
- Wheel Base :322-330mm
- Gear Ratio :1.5:1
- Weight :About 3400g

# CASTER

3



## CAUTION!!!

**Thank you for purchasing a Caster Racing Product.  
Please read all instructions and familiarize yourself with the products and control before operation.**

1. This product is not a toy. It is a high performance model product. It is important to familiarize yourself with the model, its manual, and its construction before assembly and operation, Adult supervision is necessary.
2. Always keep this instruction manual handy for your assembling and operation reference, even after completing the assembly.
3. Make sure all the screws are properly tightened and all the parts are checked after running the car for a long period of time.
4. For the best performance, it is important to make sure all the moveable parts work free without binding.
5. Do not operated model products in rain, on public roads, near crowds, near airport, or near areas with restricted radio operation.
6. Always keep fuel away from heat and open flame. Only operated in open, wellventilated area. Store fuel in cool, dry area. Keep the fuel bottle cap tightly closed. Clean up any leak or excess fuel before starting the engine.
7. This product, its parts and its construction tools can be harmful to your health. Always exercise extreme caution when assembling and or operating this product. Do not touch any moving parts of the model while operating.
8. Check your radio frequency with the proper operating frequency of the area or country. Always check to see if there are any modelers operating on the same frequency as yours. Also Check your radio for proper operation before operation a model.

# Required Equipment for Assembly

## Tools not included in Kit

Cross Wrench

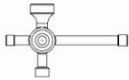

Pliers



Needle Nose Pliers



Hobby Scissors

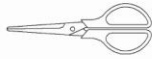

Hobby Knife



Phillips Screwdriver(#0,#1,#2)



## Included Tools

1.5mm Allen Wrench



2.0mm Allen Wrench



2.5mm Allen Wrench



3.0mm Allen Wrench



R/H 3x6mm



F/H 3x6mm



R/H 3x8mm



F/H 3x8mm



R/H 3x10mm



F/H 3x10mm

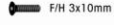

R/H 3x12mm



F/H 3x12mm



R/H 3x16mm



F/H 3x15mm



R/H 3x20mm



F/H 3x20mm



R/H 3x23mm



F/H 4x8mm



R/H 3x28mm



F/H 4x10mm



Set 3x3mm



Cap 2.5x12mm



Set 3x5mm



Cap 2.5x20mm



Set 3x12mm



Cap 3x10mm



Set 4x4mm



Cap 3x12mm

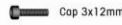

Set 4x8mm



Cap 3x23mm



Set 5x5mm



R/H 4x8mm



F/H 4x16mm



F/H 4x20mm



Notice: The below items are needed for completion of the Fusion EX-1.(KIT, PRO KIT) They are not included with this kit (unless noted). And should be obtained from your local hobby shop.

## Additional items needed for Completion



Radio



ESC



AAx8 Alkaline Batteries for Transmitter



Battery



Motor



Servo

9kg A-9849 Analog

9kg C-9850 Digital

13kg C-9851 Digital

**CASTER**

5

## Assembly of the Front & Rear differentials

# FUSION EX-1

1

### Assemble 2 Sets

Front and Rear use the same diff case, case and diff out drive.

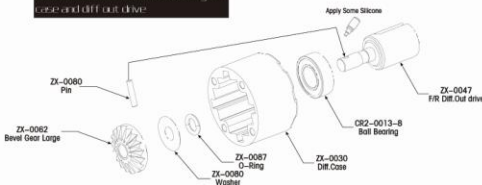

3

Fill up with silicone oil after you have installed the gear sets in the gear box.

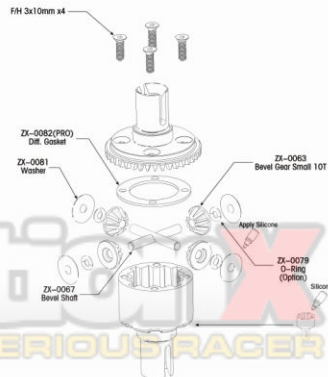

2

### Assemble 2 Sets

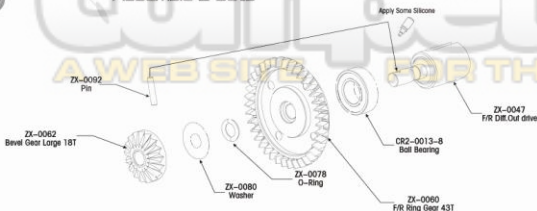

Fill differential\* is using standard set up  
Front: Silicone Oil 30000  
Mark gear based as FRONT  
Apply some grease on the O-Ring.

O-Ring ORE301500(not included) is an Option Part for Different Driving Setting

## Assembly of the Rear & Center differentials

# FUSION EX-1

4

Fill up with silicone oil after you have installed the gear sets in the gear box.

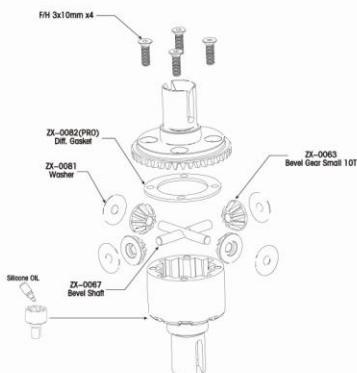

Fill differential using standard set up  
Rear: Silicone Oil 1000  
Mark gear box as REAR

5

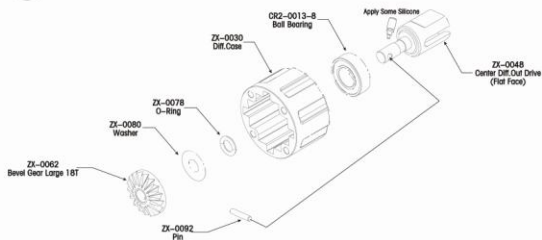

6

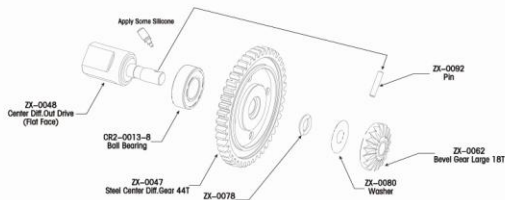

# CASTER

7

## Assembly of the REAR gearbox & Center diff.

# FUSION EX-1

7

Fill up with silicone oil after you have installed the gear sets in the gear box.

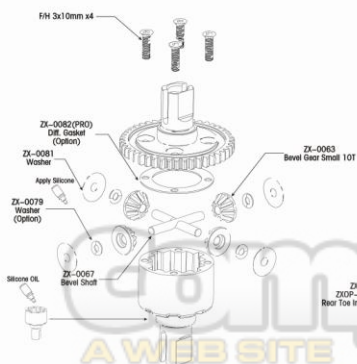

Fill differential using standard set up  
Center: 5000  
Apply some grease on the O-ring

O-Ring (CR301500) (not included) is an Option Part for Different Driving Setting

8

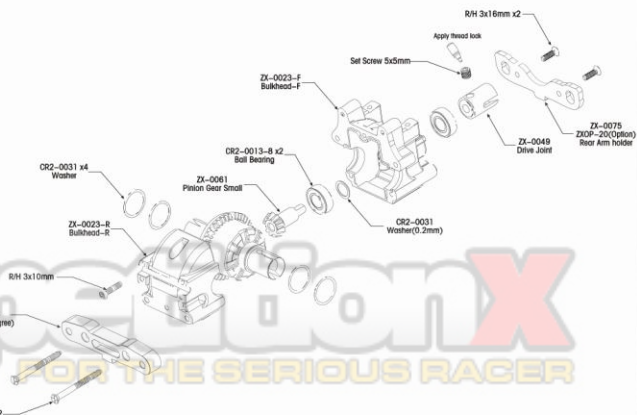

**COMPRESSION X**  
A WEB SITE FOR THE SERIOUS RAGER

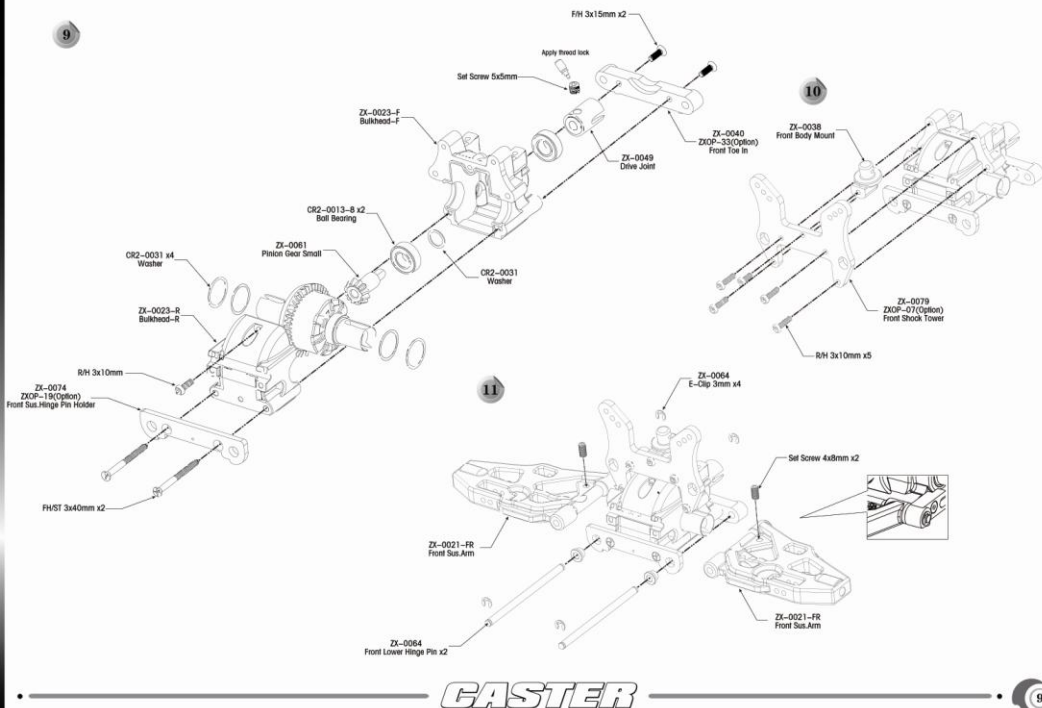

**CASTER**

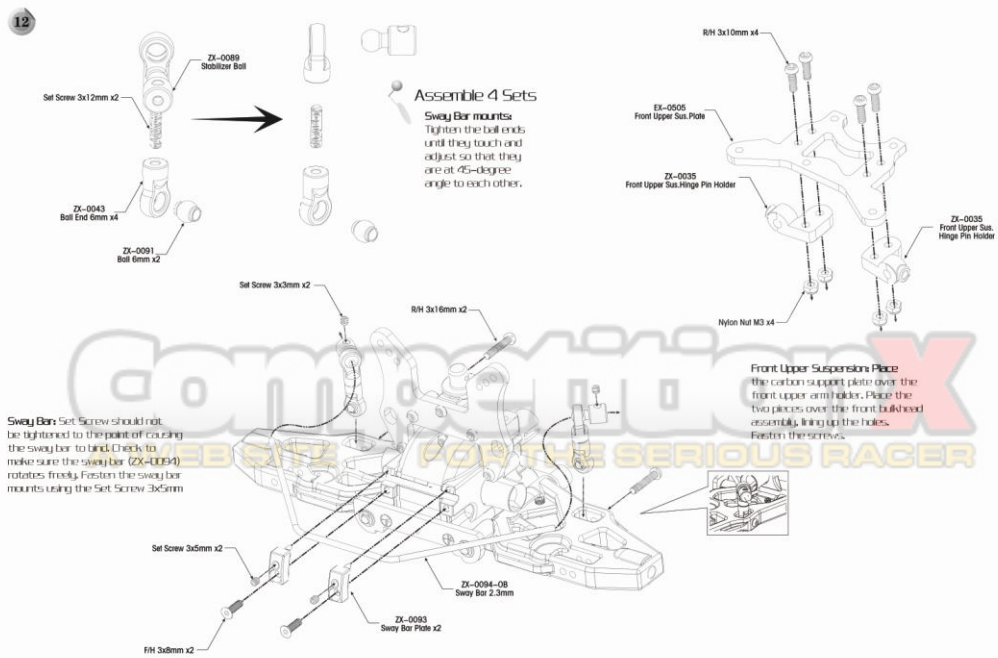

**Assemble 4 Sets**

**Sway Bar mounts:** Tighten the ball ends until they touch and adjust so that they are at 95-degree angle to each other.

**Sway Bar:** Set Screw should not be tightened to the point of causing the sway bar to bind. Check to make sure the sway bar (ZK-0094) rotates freely. Fasten the sway bar mounts using the Set Screw 3x5mm

**Front Upper Suspension:** Place the carbon support plate over the front upper arm holder. Place the two plates over the front bulkhead assembly, lining up the holes. Fasten the screws.

**COMPETITORX**  
WEBSITE FOR THE SERIOUS RAGER

14

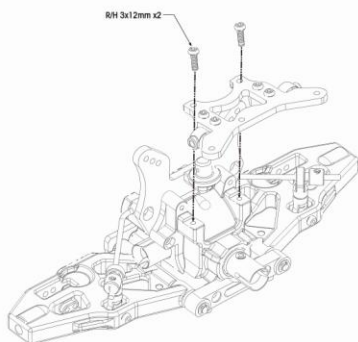

15

### Front Upper Arms

Place the Hinge Pin through the Front upper Toe-in adjuster .  
 Attach e-clips to the end of each upper hinge pin in the grooves.  
 Place the arms between the shock tower and upper arm holder.  
 Slide the pins into the front upper suspension holder.  
 After sliding the pins, between the shock tower and upper arm holder, make sure the flat portion of the hinge pins, facing out. Tighten the 4x6mm set screw.  
 Check for free movement of the upper arm.

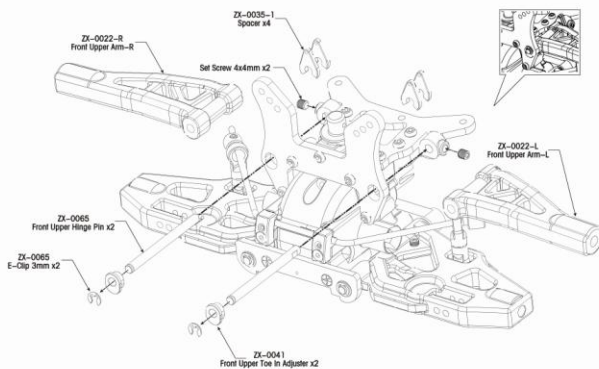

11

16

Assemble both right and left sides

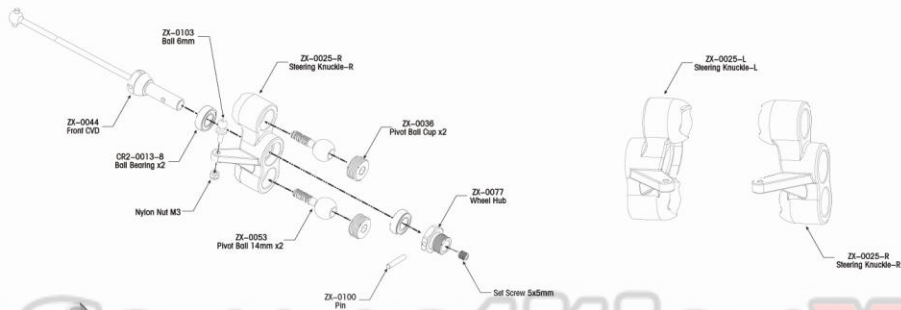

17

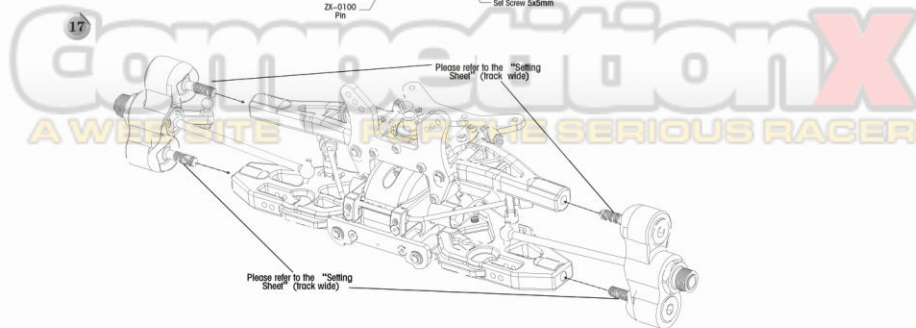

18

19

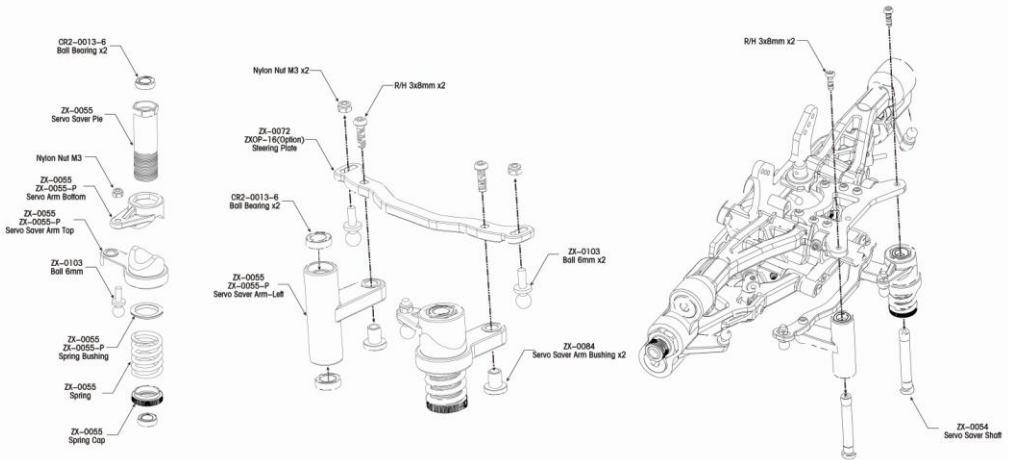

13

20

21

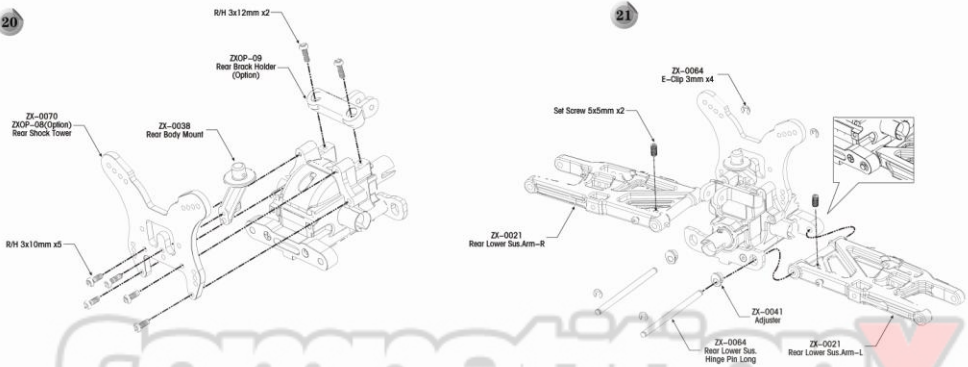

22

Sway Bar Set Screw should not be tightened to the point of causing the sway bar to bind. Check to make sure the sway bar (ZX-0095) rotates freely. Fasten the sway bar mounts using the Set 3x5mm

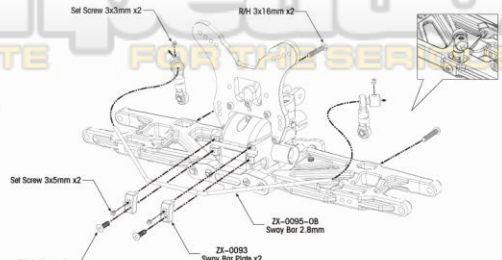





Mounting the differentials on the chassis

# FUSION EX-1

27

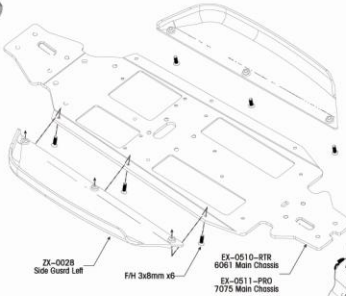

28

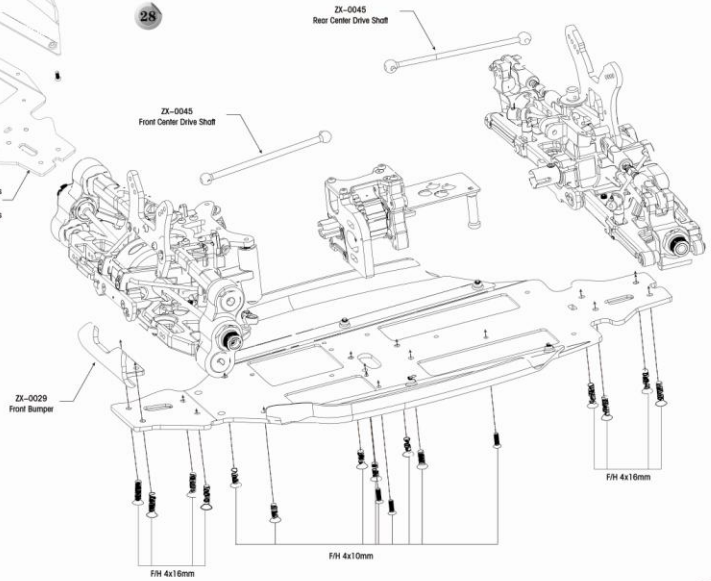

CASTER

17

Mounting the parts on the chassis

# FUSION EX-1

29

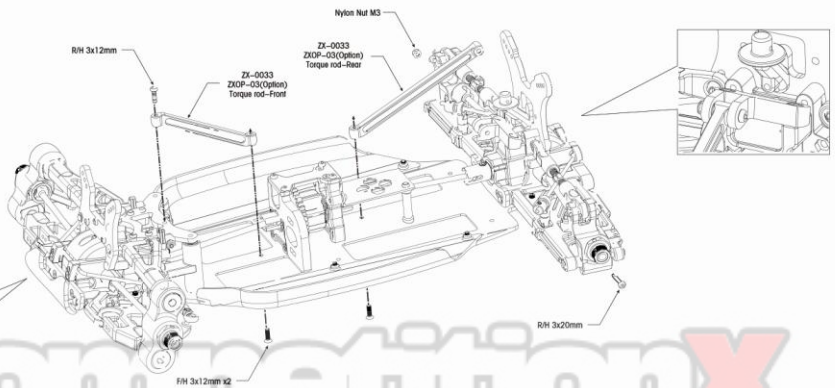

30

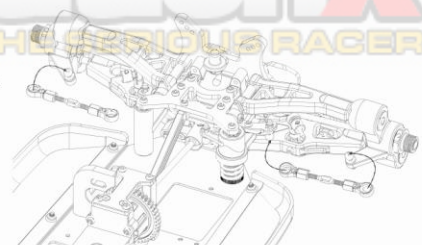
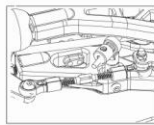
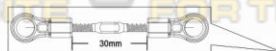
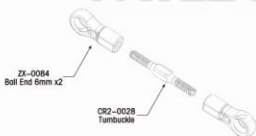

Competition X  
A WEB SITE FOR THE SERIOUS RAGER



35

Assemble 2 Sets

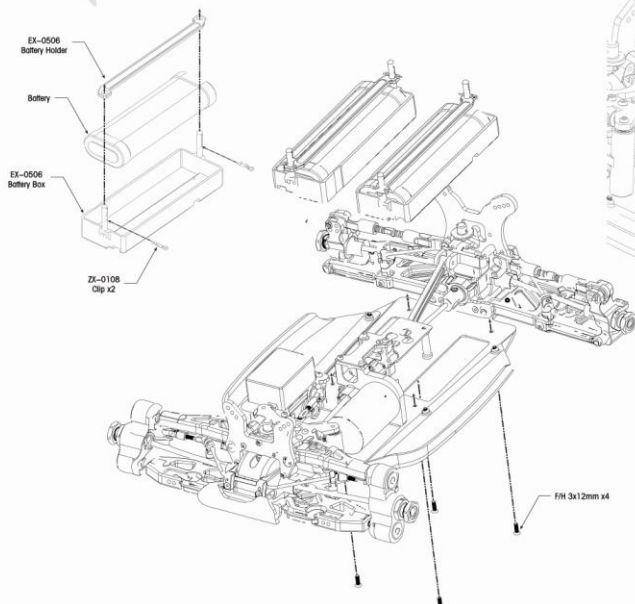

36

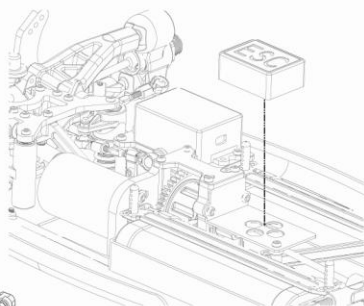

CASTER

21

37

Front Shock

Slide the W5266050 washer over the stopped end of the shock shaft. Place the PL0001-4E3 over the shaft and washer. Tighten the piston in place using the S90060 lock nut. Make sure you don't over-tighten the piston, it will cause damage to the shape of the piston. Repeat for the 3 other shock shafts.

Apply a drop of Shock Oil to the O-rings (O-RING190). Place the O-ring, followed by Shock Collar (PL0002), another O-ring (O-RING190), follow by Shock Collar again (PL0002). Gently press the PL0002 to seat the parts in the shock body and under the small groove. Carefully place the G-Ring (S9000) in the shock body and snap into the groove.

Apply a drop of Shock Oil to the threads of the shock shaft. Gently slide the shock shaft through the shock body. Tighten the shock shaft ball end to the top of the threads. Snap the G3mm Ball (G30002) into the Ball End (PL0006).

39

Assemble 4 Sets Use Shock Oil #400

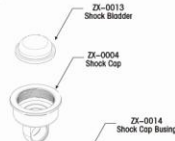

Apply a drop of Shock Oil to the Shock Blotter (ZK0013). Spread the oil all around the blotter in the shock cap, past the threads. Slide the shock cap, pushing into the shock cap.

Push the shock shaft to the bottom, and fill the shock oil to full. Push the Shock Shaft all the way to the top (slowly). And then pull the shaft back down very very slow to bottom. Repeat this process at least twice, to make sure that there will be no air bubbles.

Make sure there isn't any bubbles in the shock. You can start to thread the Shock Cap. Make sure when it threads the cap, the shaft is at the bottom position.

38

Assemble 2 Sets

Assemble 2 Sets

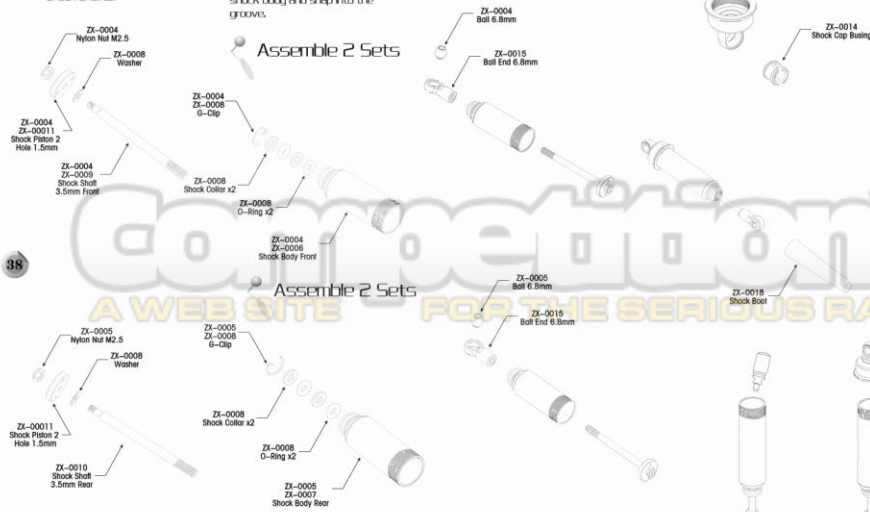

Go to our website for the serious racer

It will lock from here.

40

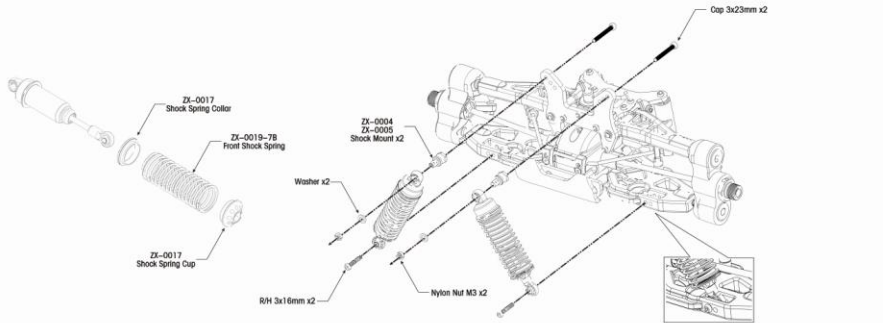

41

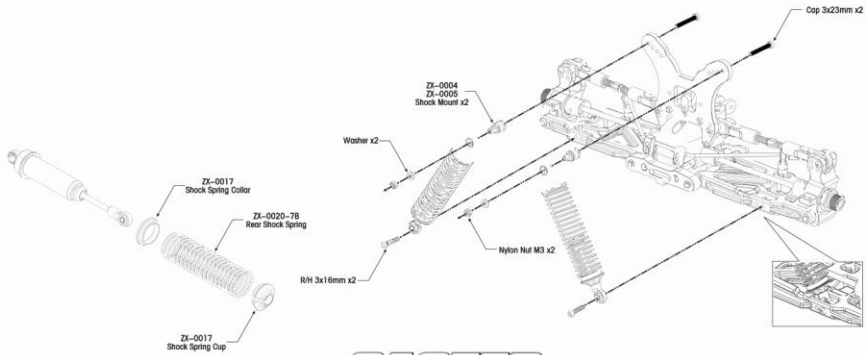

**CASTER**

28

42

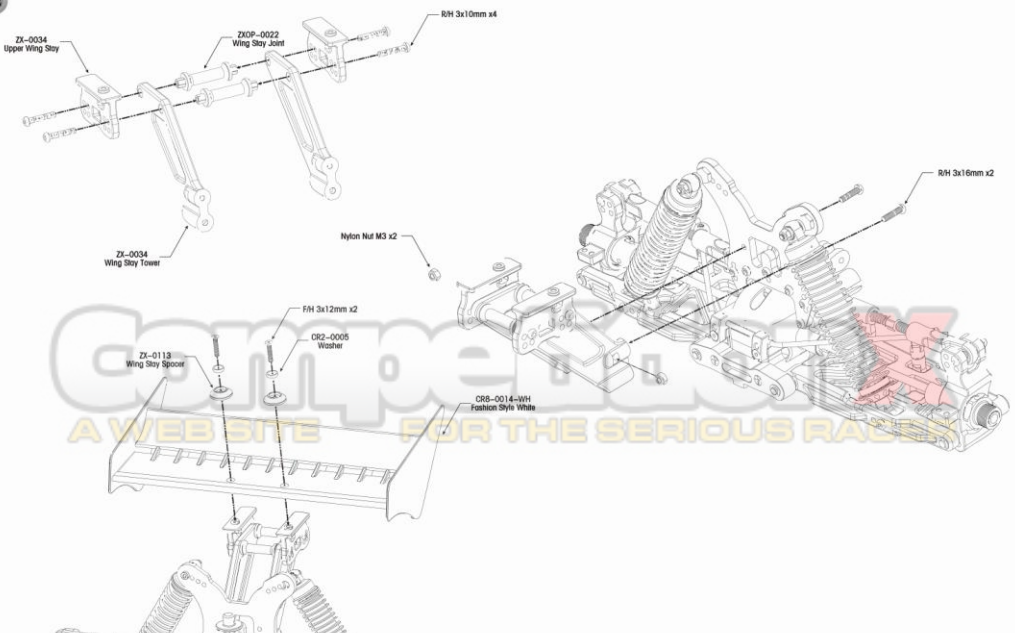

A WEB SITE FOR THE SERIOUS RACER

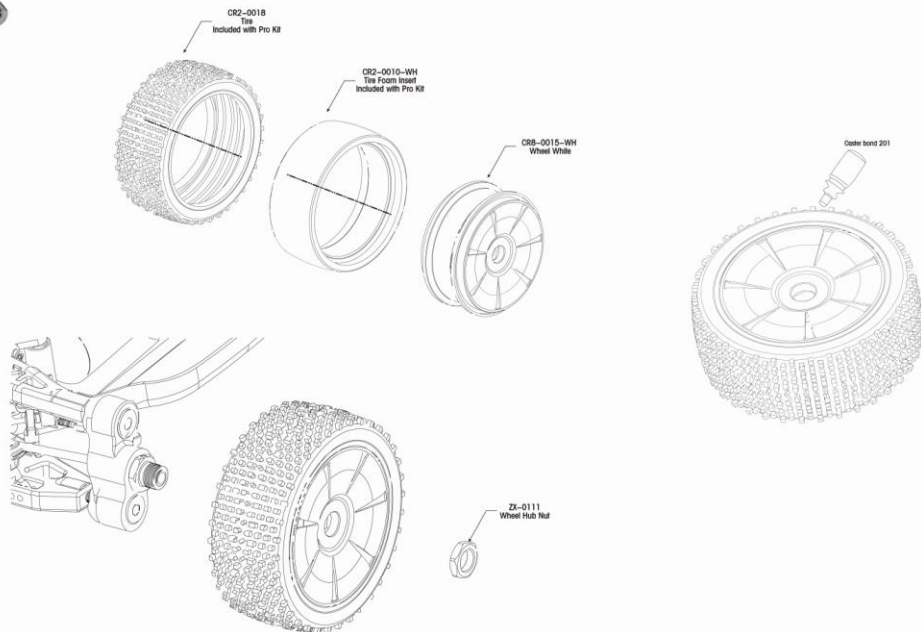

## Tips and guide for running your Fusion EX-1

Congratulations on your purchase of the Caster Racing Fusion EX-1. Your new Fusion EX-1 should provide you with several years of high performance excitement with proper use and maintenance. Since it is a high performance vehicle, adult supervision is recommended for anyone under the age of 16. Depending on the parts you use, it is capable of speeds up to 70 mph and can cause injury or even death if used in an unsafe manner.

The Fusion EX-1 Sport will require some additional parts. Getting the proper electric motor, electronic speed controller, and batteries are vital to its performance. You will have several choices and we have made several recommendations on our website. Please go to [www.casterracingusa.com](http://www.casterracingusa.com) and join the forums for details. Improper parts will cause poor performance, excessive wear, and potential damage to your Fusion EX-1. Make sure you follow recommendations and directions provided.

1. Use only the parts recommended by Caster Racing and get them from a reputable hobby store. Using parts from other devices could result in damage to your Fusion EX-1. There could be a potential risk of electrical shorts, battery explosions, or even fire if you install or use these parts improperly.
2. Always follow the manufacturer's instructions for charging, discharging, programming, and usage and adhere to all safety rules they provide. Make sure there are no potential short circuits and make sure the batteries are properly charged before use.

### Radio System:

In order to run your Caster Fusion EX-1 without any loss of control, please make sure you have checked the following requirements:

1. It is important that all the batteries are fresh or fully charged.
2. Always check the path and the condition of the battery pack wires as well as the switch wires. A broken wire can cause a short circuit and lead to a loss of control.
3. Turn on the transmitter, and then turn on the car receiver battery pack switch to check the steering servos' movement and the ESC controller operation.
4. Turn the steering wheel on the transmitter left and right. The front wheels should turn left and right (when viewed from behind). Use the steering trim adjustment to set the neutral (wheels pointing straight ahead) setting on your car. If your servos move very slowly, check your batteries.
5. Pull the throttle trigger, the wheels should spin forward. Push the throttle trigger forward. This will activate the brakes. Please use the throttle trim adjustment to set the neutral setting on your car. (Read the instructions that come with your radio.)
6. If the vehicle is not responding in regards to movement, double check your wiring and refer to the troubleshooting manual of your electronic speed controller. Otherwise, call our phone number or go online for tech support.

### **Warning!!!**

1. Improper operations may cause personal and/or property damage. Caster Racing and its distributor have no control over damage resulting from shipping, improper construction, or improper usage.

### **Motor:**

For proper motor break-in procedure, please refer to the manual of your motor and electronic speed controller.

1. Never run your vehicle without the batteries properly charged and maintained.
2. The parts around and including the motor could be dangerously hot after operation. Do not touch it without any protection!

### **OPERATING YOUR FUSION RC CAR:**

The 1/8th scale electric car runs at a very fast speed, and uses expensive parts. It is designed for r/c racing applications and is not a toy. Operate the model in the area with safety in mind. Make sure there is no personal injury, no property damage, and there are no accidents.

### **Checklist Before Running**

1. Be sure to tighten screws securely and install all parts.
2. Ensure all moving parts move without binding. Are they greased or siliconed to prevent binding?
3. Ensure all electronics are properly secured and shimmed correctly.
4. Turn on the switch of the receiver and transmitters, and make sure whether the steering servo linkages move without binding and that the electronic speed controller is working properly.
5. Check the radio batteries are fresh and make sure they are fresh enough to operate the model.
6. Check if there is someone on the same frequency.

### **IMPORTANT !!! Do not operate the Car under these situations !!!**

1. Near Children
2. Early morning and late night.
3. Near railroad tracks, streets, schools, or anywhere where people might get hit accidentally.
4. When the batteries of the transmitter and/or receiver are weak.
5. When the model car is behaving strangely due to other people on the same frequency or low voltage issues.

• ————— **CASTER** ————— •

27

### **Starting Procedures**

1. Make sure the batteries are fresh.
2. Turn on the switch of the transmitter and receiver.
3. Make sure the steering servo and e.s.c work normally and adjust them correctly.

### **Finishing Procedures**

1. Turn off the receiver and transmitter switch.
2. Remove batteries for storage and follow manufacturer recommendations for charging/discharging batteries.

### **Maintenance**

1. Before storing your car away, Wipe off dirt and oil and grease all moving parts.
2. Check for loose screws and parts and tighten them accordingly.

**CompetitionX**  
A WEB SITE FOR THE SERIOUS RAGER

## Spare parts



ZX-0003  
EX-1 Caster Sticker Sheet

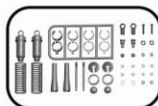

ZX-0004  
Front Shock Set



ZX-0005  
Rear Shock Set



ZX-0006  
Front Shock Body



ZX-0007  
Rear Shock Body

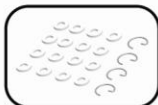

ZX-0008  
Shock Rebuild Kit



ZX-0009  
Front Shock Shaft



ZX-0010  
Rear Shock Shaft

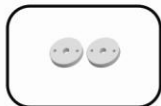

ZX-0011  
Shock Piston 2-hole 1.5mm

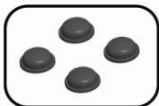

ZX-0013  
Shock Bladders

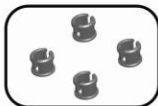

ZX-0014  
Shock Cap Bushing



ZX-0015  
Shock Shaft Ball End

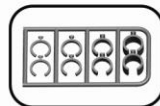

ZX-0016  
Shock Spring Adjuster Set



ZX-0017  
Shock Spring Cup Set  
(Up & Down)

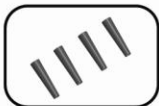

ZX-0018  
Shock Boots

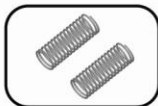

ZX-0019-7B  
Shock Spring - Front Blue  
1.7mm

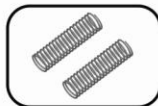

ZX-0020-7B  
Shock Spring - Rear Blue  
1.7mm



ZX-0021-FR  
Front and Rear Lower  
Suspension Arms

**CASTER**

29

## Spare parts



ZX-0022  
Front Upper Suspension Arms



ZX-0023  
Gear Case x 2box



ZX-0024  
Center Diff Mount Set

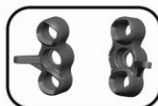

ZX-0025  
Front Steering Set Left & Right

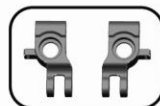

ZX-0026  
Rear Hub Set



EX-0506  
Battery Box



ZX-0028  
Side Guards

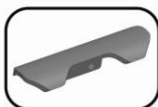

ZX-0029  
Front Bumper



ZX-0030  
Differential Case

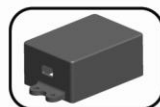

EX-0502  
Receiver Box



ZX-0033  
Chassis Brace Set  
(Front & Rear)



ZX-0034  
Wing Stay Set



CR8-0013-WH  
Wing Yellow



ZX-0035-01  
PL0055 caster clip spacer



ZX-0035  
Front Upper Sus. Hinge Pin Holder

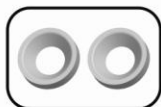

ZX-0036



ZX-0037



ZX-0038



ZX-0039



ZX-0040

## Spare parts

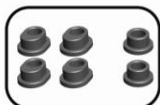

ZX-0041  
Front/Rear Toe-In adjuster



ZX-0042  
Rear Upper Arm-Ball  
End 7mm



ZX-0043  
Sway Bar Mount-Ball  
End 3mm



ZX-0044  
Front Universal Drive



ZX-0045  
Front Center & Rear Center  
Drive Shaft



ZX-0046  
Rear Drive shaft



ZX-0047  
Diff. Drive



ZX-0048  
Center Diff. Out Drive  
(Flat Face)



ZX-0049  
Drive Joint



ZX-0050  
Rear Wheel Axle

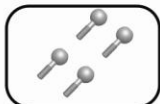

ZX-0053  
14mm Steering Pivot Ball



ZX-0054  
Steering Servo Saver Post



ZX-0055  
Servo Saver Full Set



ZX-0055-P  
Servo Saver Plastic parts



ZX-0056  
Shock Bushing

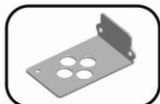

EX-0507  
ESC Control holder



ZX-0058  
Rear Upper Suspension  
Turnbuckle

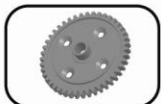

ZX-0059  
44T Steel Spur Gear



ZX-0060  
43T Diff Gear



ZX-0061  
13T Pinion Gear

**CASTER**

31

## Spare parts

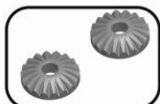

ZX-0062  
18T Diff Bevel Gear

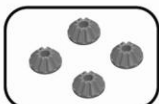

ZX-0063  
10T Diff Bevel Gear



ZX-0064  
Front Lower Suspension  
Hinge Pin

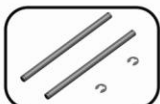

ZX-0065  
Front Upper Suspension  
Hinge Pin



ZX-0066  
Rear Hub Hinge Pin



ZX-0067  
Diff. Bevel Gear Shaft

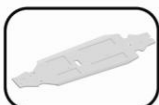

EX-0511-PRO  
CNC Main Chassis

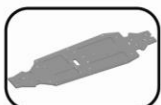

EX-0510-RTR  
Main Chassis



ZX-0069  
Front Shock Tower 6061



ZX-0070  
Rear Shock Tower 6061



ZX-0071  
Front Support Plate 6061

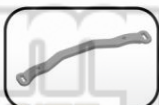

ZX-0072  
Steering Plate 6061



EX-0509  
Center Diff. Support Plate



ZX-0074  
Front Suspension Arm Holder



ZX-0075  
Rear Suspension Arm Holder

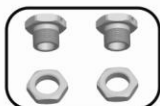

ZX-0077



ZX-0078

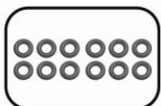

ZX-0079

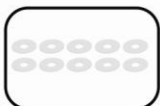

ZX-0080

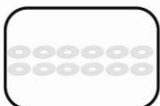

ZX-0081



## Spare parts

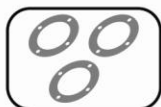

ZX-0082  
Diff. Gasket



EX-0503  
Radio Plate Out



ZX-0084  
Steering Ball End



ZX-0086  
Servo Saver Arm Bushing

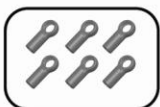

ZX-0087  
Servo Ball End 6mm (plastic)

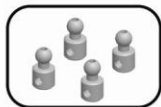

ZX-0089  
Stabilizer Ball 6mm

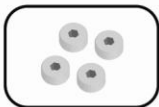

ZX-0090  
Cup Holder Busing

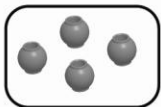

ZX-0091  
Ball 6mm

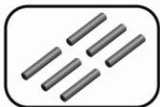

ZX-0092  
Diff. Pin



ZX-0093  
Sway Bar Plate (plastic)



ZX-0094-0A  
Front Sway Bar 2.2mm



ZX-0094-0B  
Front Sway Bar 2.3mm



ZX-0094-0C  
Front Sway Bar 2.4mm



ZX-0095-0A  
Rear Sway Bar 2.7mm



ZX-0095-0B  
Rear Sway Bar 2.8mm



ZX-0095-0C  
Rear Sway Bar 2.9mm



ZX-0100  
Wheel Hub Pin

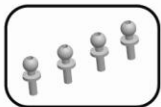

ZX-0103  
6mm Steering ball with  
screw thread



ZX-0104  
Servo Horn Convert F,K,H,S.



ZX-0105  
Rear Upper Arm Ball End  
Plastic - Nike Style.

**GASTER**

## Spare parts

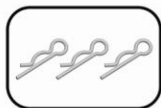

ZX-0108  
Body Pin



ZX-0110  
Wheel Hub



ZX-0111  
Wheel Nut

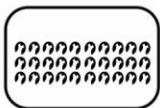

ZX-0112  
E-Clips 3mm



ZX-0113  
Wing Stay Spacer



CR2-0018  
1/8 Buggy Tire (Square)



CR8-0015-WH  
Wheel White



ZXOP-09  
Rear Brack Holder ( Option )



EX-0503-01  
Radio Plate In



EX-0501  
13T Gear



EX-0504  
Motor engine mount

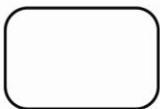
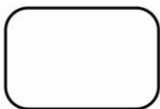
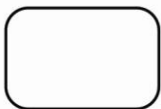
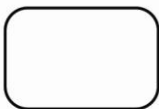
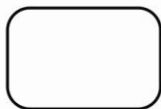
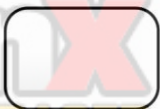

GASTER  
WEB SITE FOR THE SERIOUS RACER

# FUSION EX-1

# Blank Setup Sheet

118 OFF-ROAD NITRO BUGGY  
**CASTER RACING TEAM**

Name: \_\_\_\_\_ Date: \_\_\_\_\_  
 Track: \_\_\_\_\_ Weather: \_\_\_\_\_

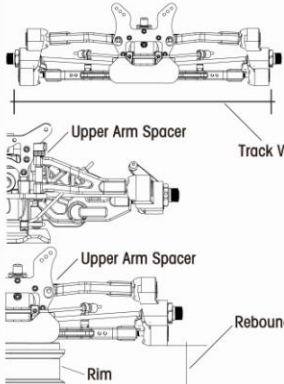

Track Width: \_\_\_\_\_ mm  
 Camber Angle: \_\_\_\_\_ °  
 Upper Arm Spacer: \_\_\_\_\_ mm  
 Toe Angle: \_\_\_\_\_ °  
 Rebound Stop: \_\_\_\_\_ mm  
 Anti-roll Bar:  Use \_\_\_\_\_ mm  
                    None  
 Lower Arm Mount (kick up): \_\_\_\_\_ °  
 Upper Arm Position: ZX-0041  
     
 Lower Arm spacer: \_\_\_\_\_ mm

Piston: \_\_\_\_\_  
 Oil: \_\_\_\_\_  
 Spring: \_\_\_\_\_  
 Spacer: \_\_\_\_\_ mm  
 Shock Position: \_\_\_\_\_

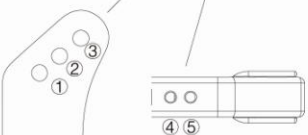
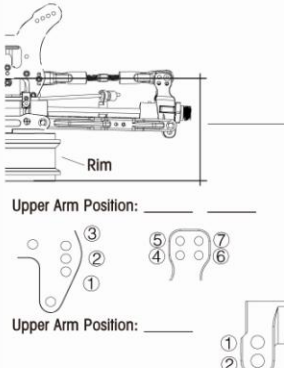
Camber Angle: \_\_\_\_\_ °  
 Lower Arm Mount: ( Toe Angle ) \_\_\_\_\_ °  
 Rebound Stop: \_\_\_\_\_ mm  
 Anti-roll Bar:  Use \_\_\_\_\_ mm  
                    None  
 Anti-Squat:    
 Wheelbase Adjustment \_\_\_\_\_ mm  
 Front

Piston: \_\_\_\_\_  
 Oil: \_\_\_\_\_  
 Spring: \_\_\_\_\_  
 Spacer: \_\_\_\_\_ mm  
 Shock Position: \_\_\_\_\_

\_\_\_\_\_  
 \_\_\_\_\_  
 \_\_\_\_\_

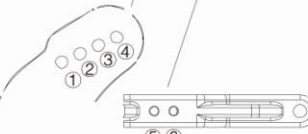
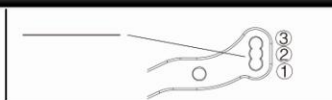
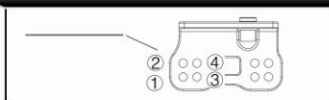
Front: # \_\_\_\_\_ O-Ring \_\_\_\_\_ pcs.  
 Center: # \_\_\_\_\_ O-Ring \_\_\_\_\_ pcs.  
 Rear: # \_\_\_\_\_ O-Ring \_\_\_\_\_ pcs.

Front: Tyre: \_\_\_\_\_ Tyre: \_\_\_\_\_  
 Rim: \_\_\_\_\_ Rim: \_\_\_\_\_  
 Insert: \_\_\_\_\_ Insert: \_\_\_\_\_

Race Time / Laps: \_\_\_\_\_  
 Position in Race: \_\_\_\_\_  
 Best lap: \_\_\_\_\_

**CASTER**  
RACING

[www.casterracing.com](http://www.casterracing.com)  
[info@casterracing.com](mailto:info@casterracing.com)

CompetitionX  
A WEB SITE FOR THE SERIOUS RACER